

RIQUADRO -I- ALTIMETRICA 159.60 - ALTIMETRICA 168.69
 Progressiva 1232.97 - Progressiva 1393.19



COMUNE DI MASSA LUBRENSE (NA)
 AREA ARCHEOLOGICA PUNTA CAMPANELLA:
 "RESTAURO MANUFATTI E ABBATTIMENTO
 BARRIERE ARCHITETTONICHE
 VIA CAMPANELLA

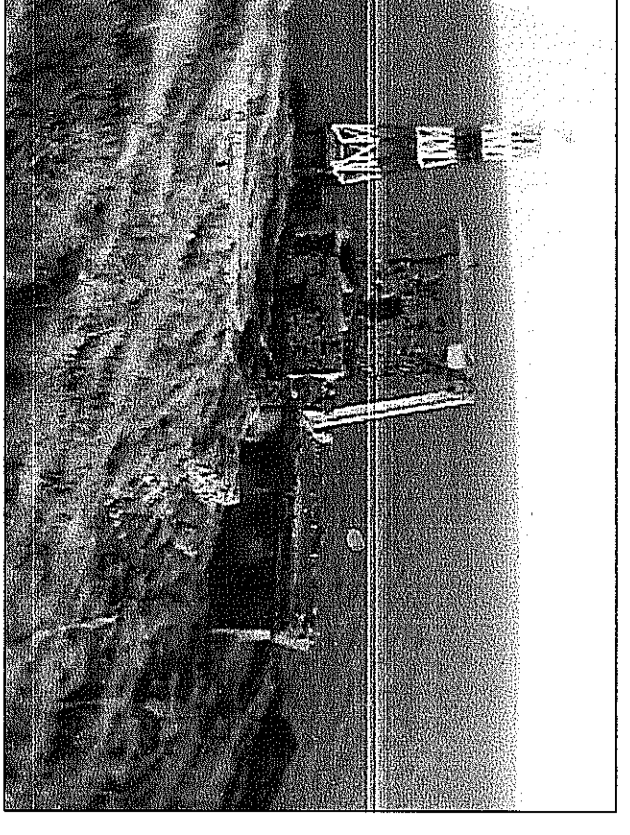

PROGETTO ESECUTIVO

PROGETTO QUOTI CON INDICAZIONE DEGLI APPALTI
 TRATTO I - PROGRESSIVE (1232.97 - 1393.19)

() ESTESE (●) APPROVATO (○) STUDIO (○) PRELIMINARE	DATA 17/10/20 11/11/20 09/12/20 21/12/20	PPI T.100/50 2005
PROGETTO ARCH. MAURIZIO SCHIAZZA PROGETTISTA		

26

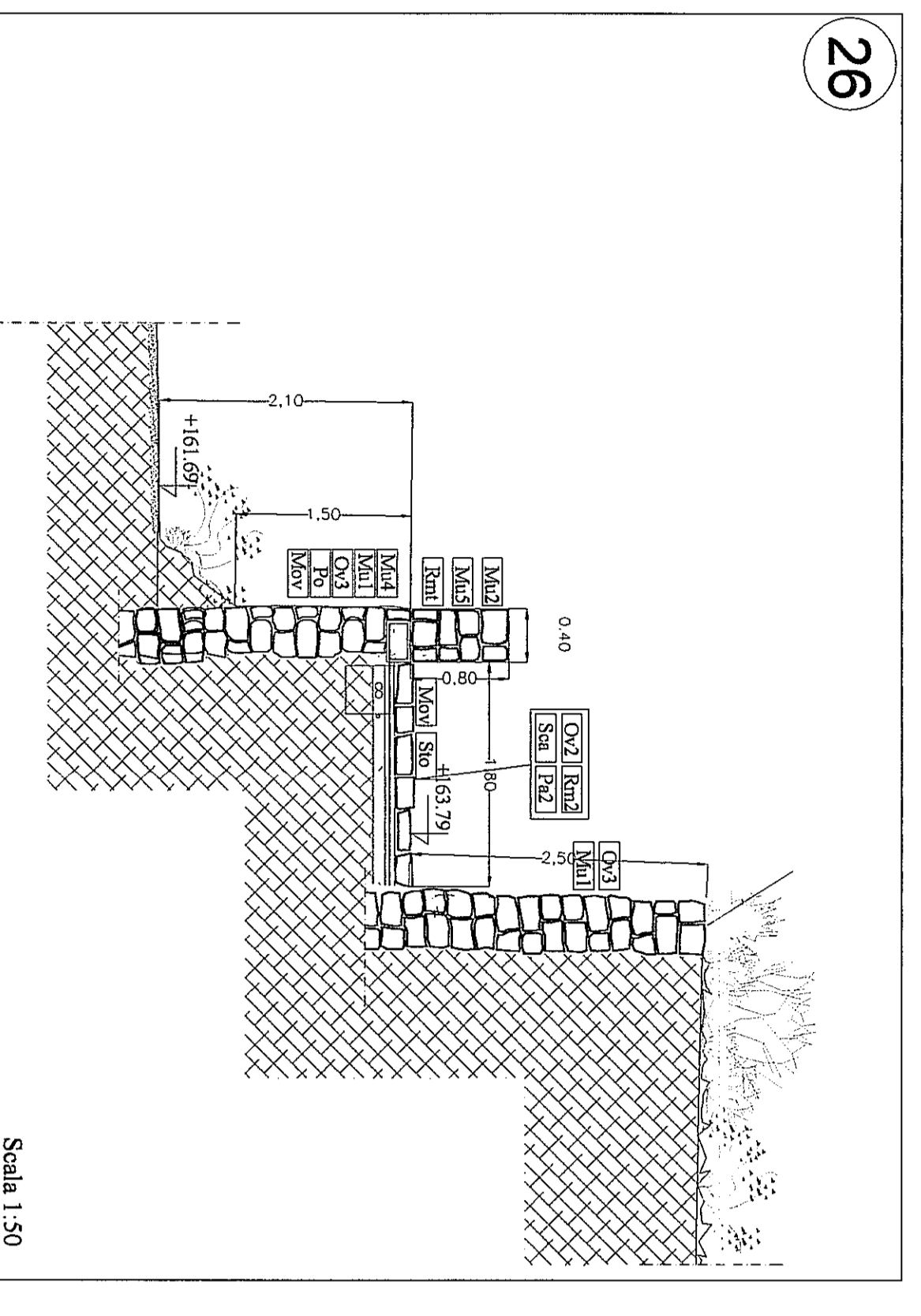

27

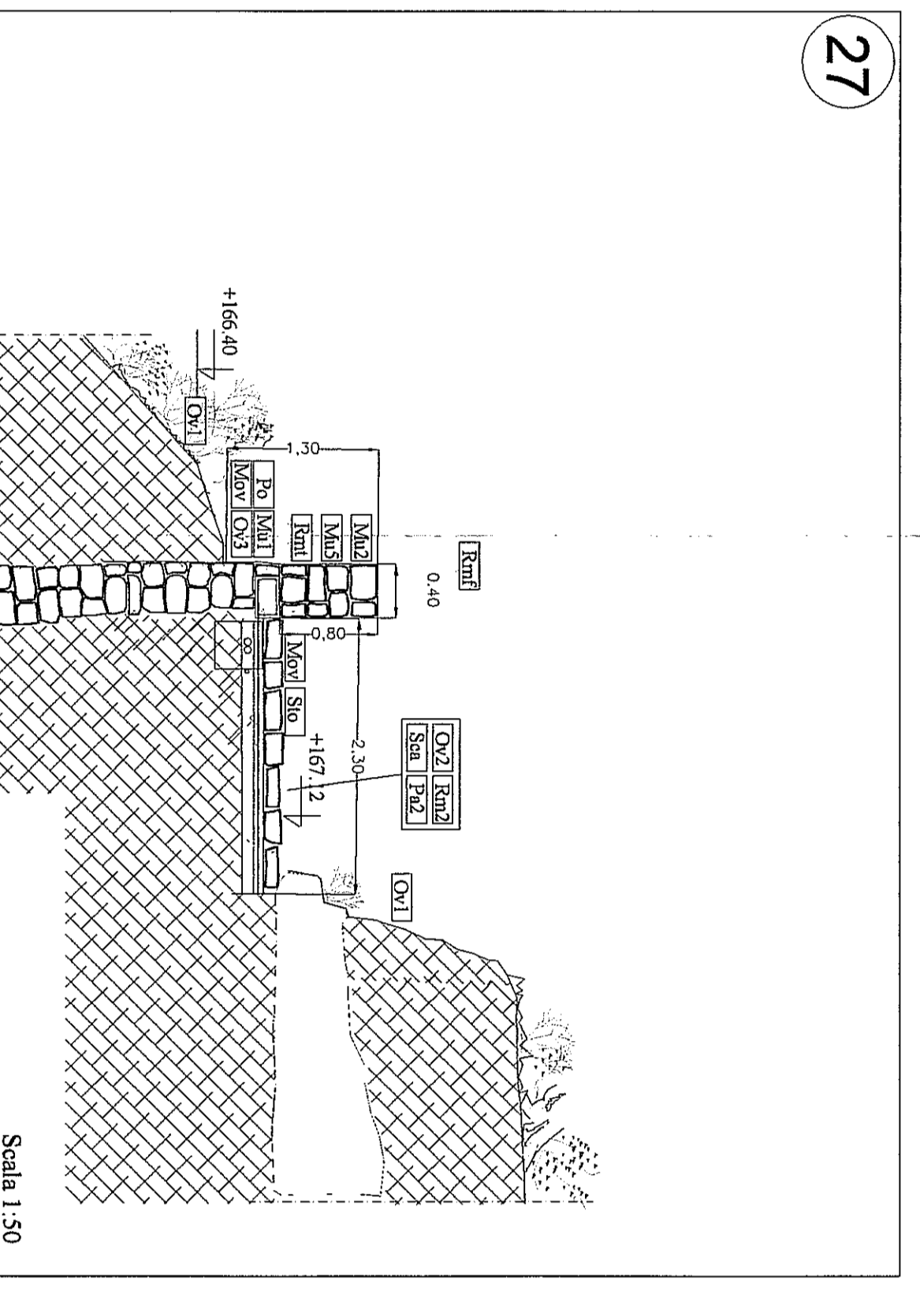

28

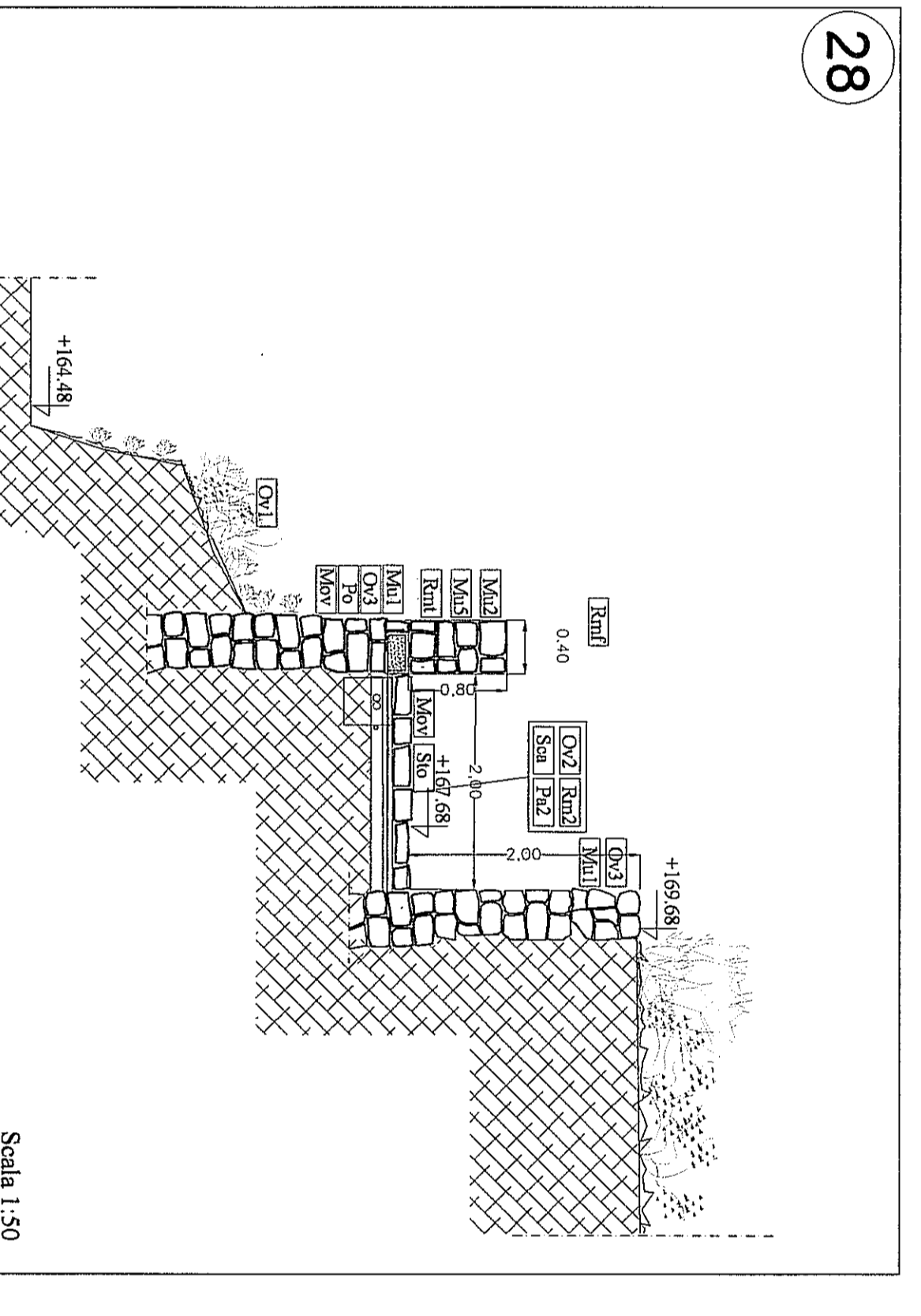

PROGR.